

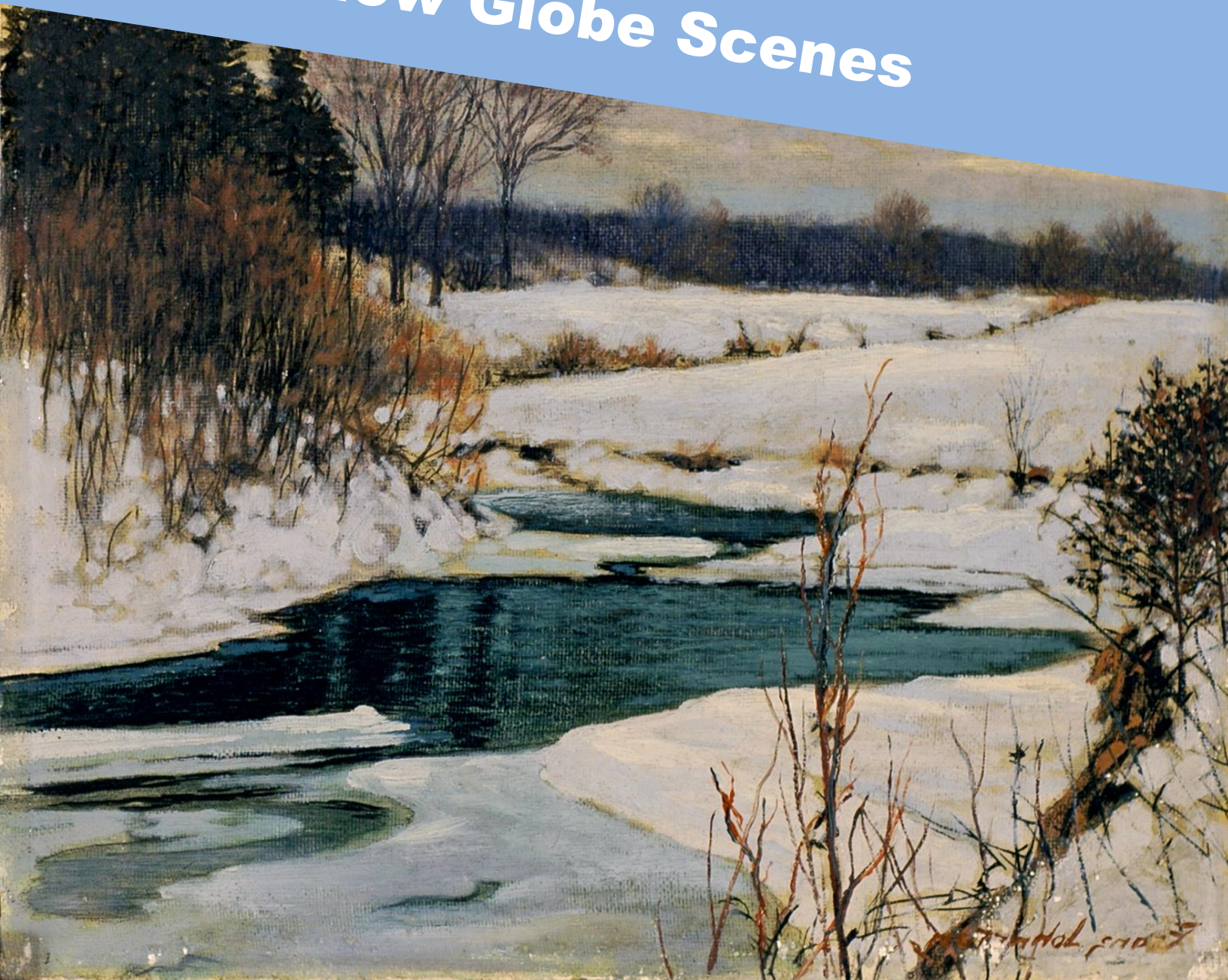

PEEL
ART GALLERY
MUSEUM +
ARCHIVES

PAMA @ Home
Home for the Holidays
Snow Globe Scenes



Frank (Franz) Johnston, Canadian (1888-1949), *Close of Day*, n.d., oil on Masonite
29.2 x 34.2 cm, Peel Art Gallery, Museum and Archives,
Gift of the Peel County Historical Society, 1982



Snow Globe Scenes

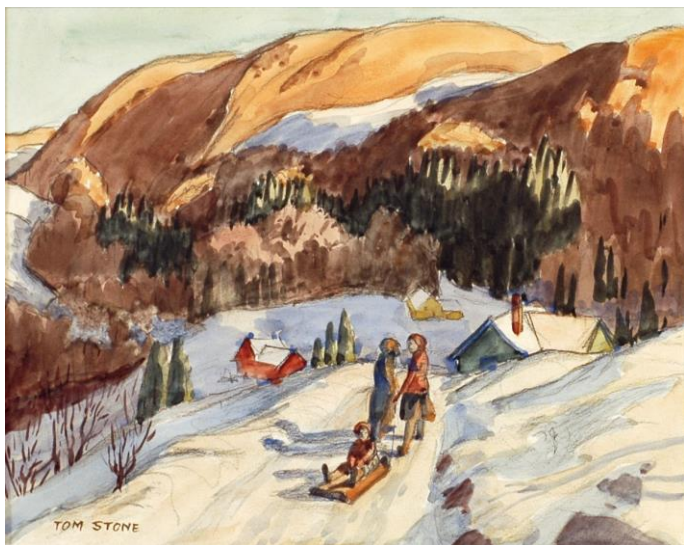

Tom Stone, British (1896-1978)
Early Days at the Forks of the Credit, c. 1935
watercolour on paper
21 x 26 cm
Peel Art Gallery, Museum and Archives
Gift of the Peel County Historical Society, 1977

Winter scenes and landscapes are full of beauty and majesty, just like the watercolour *Early Days at the Forks of the Credit*.

Use your imagination or your local landscape to get inspired and create your own snow globe winter scene.

Materials:

- White Paper
- Construction Paper
- Pencil
- Scissors
- Glue Stick
- Markers/Pencil Crayons

Step One:

Fold your white paper like an accordion from the bottom upwards until you've reached about 3/4 of the way up.

Then, fold your paper in half horizontally and glue both edges together.

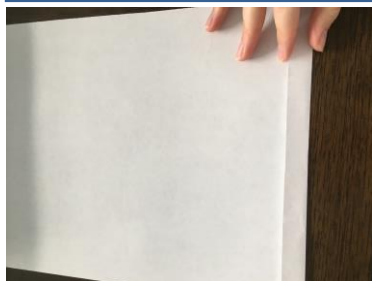

This activity is provided to you by:

Step Two:

Cut a coloured piece of construction paper to the width of your white paper in a semi-circular shape.

Create the background by using a glue stick to attach your coloured piece of construction paper to the remaining 1/4 of your white paper.

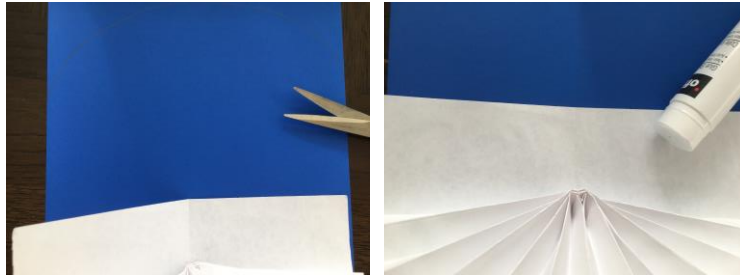

Step Three:

Create trees, houses or snow people with other colours of construction paper and decorate them with markers.



Step Four:

Glue your finished pieces onto your background and onto your white paper to complete your snow globe scenes.



This activity is provided to you by: